



**Beaver Plastics**

# TERRAFOAM<sup>®</sup> EPS

Expanded Polystyrene Insulation

TERRAFOAM is an inert closed cell expanded polystyrene (E.P.S.) insulation material. It has excellent resistance to freeze/thaw and has zero capillarity and low moisture absorption properties. TERRAFOAM will never rot, or support mold or mildew.

TERRAFOAM is suited to a wide range of applications because of its excellent physical and chemical properties, and economical cost. It is manufactured in a range of densities, in order to meet specific application requirements. Standard sheet sizes are 2'X8' (610mm x 2440mm) and 4'X8' (1220mm x 2440mm), but TERRAFOAM is also produced to custom sizes, with edges plain or shiplapped. TERRAFOAM contains ordinary air; not refrigerant gases. This means that insulating properties do not degrade over time.

The following is a sampling of common applications.

- Above-grade cladding under stucco, siding
- Masonry Cavity Walls
- Exterior Insulated Finish Systems (E.I.F.S.)
- Conventional and Slope-to-Drain Roofing
- Floatation applications
- Under concrete slabs on grade
- Grade beams, foundation walls, shallow foundations
- Coolers, Freezers, and ice arenas
- Hot Tub Covers
- Packaging, protection, container linings

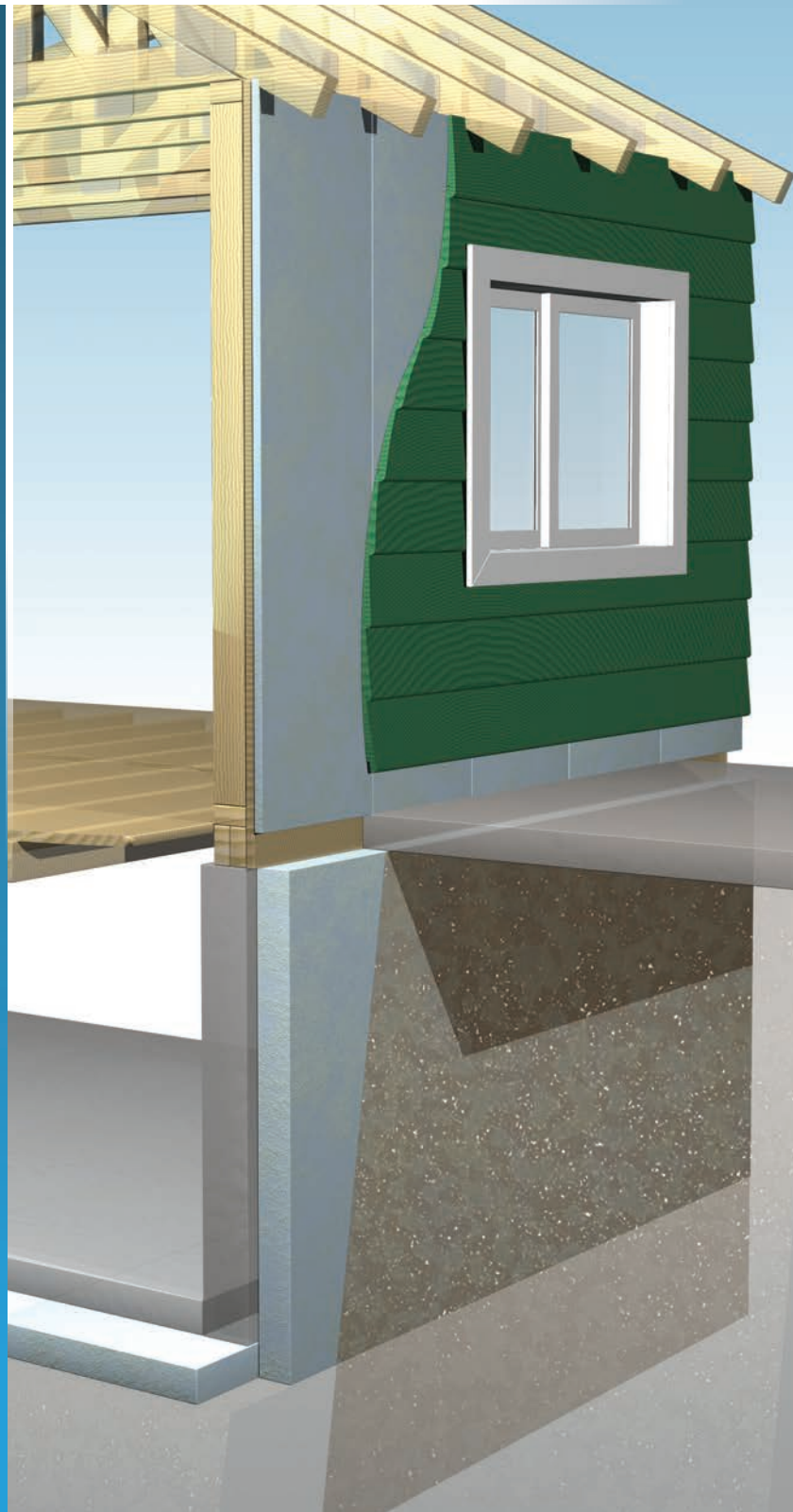

## TERRAFOAM PHYSICAL PROPERTIES

PHYSICAL PROPERTY	UNITS IMPERIAL R VALUE	UNITS SI (METRICS)	ASTM TEST PROCEDURE	TERRAFOAM TYPE 1		TERRAFOAM TYPE 2		TERRAFOAM TYPE 3	
				Imperial	Metric	Imperial	Metric	Imperial	Metric
Minimum Thermal Resistance (R-Value)	hr. ft <sup>2</sup> °F BTU /1 in.	m <sup>2</sup> °C W/25mm	C-177-93 @ 0°C (32°F)	4.07	0.72	4.40	0.77	4.62	0.81
			C-177-93 @ 24°C (75°F)	3.75	0.65	4.04	0.70	4.27	0.74
Compressive strength (min)	psi	k.Pa	D 1621-73	10	70	16	110	20.4	140
Capillary Action	---	---	---	none	none	none	none	none	none
Water vapor permeance (max)	perm - in	ng/Pa.s.m <sup>-2</sup>	E 96-80	5.25	300	3.5	200	2.25	130
Water absorption % (max)	%	%	48	6.0	6.0	4.0	4.0	2.0	2.0

Terrafoam is a breathable insulation product, permitting the transmission of water vapour. It can, therefore, be used as an external insulation for renovation and/or new construction without the potential for creating an exterior vapour barrier that would trap moisture in the wall cavity, causing serious building deterioration.

### CHEMICAL PROPERTIES

Expanded polystyrene should not be exposed to volatile hydrocarbons, such as fuels oils, gasoline, and some alcohols. Anhydrous acids, such as sulfuric, glacial and formic acid may also attack expanded polystyrene.

### HEALTH AND THE ENVIRONMENT

TERRAFOAM is one of the few foam plastic insulations available that contains absolutely no CFCs, HCFCs, or other refrigerant gases. It is non-toxic and hypo-allergenic, and will not irritate sensitive skin on exposure.

### FLAMMABILITY CHARACTERISTICS

TERRAFOAM contains a chemical additive to inhibit accidental ignition from a small fire source. This additive, however, will not prevent burning when the material is exposed to a large continuous fire source or intense heat. Observe normal fire precautions and good housekeeping methods during application. Cover insulation with a finish acceptable to local building codes.

## TERRAFOAM PHYSICAL PROPERTIES

Bundle Style	Bundle Dimensions	Type 1 Weight/Bdle	Type 2 Weight/Bdle	Type 3 Weight/Bdle
Roofing	24" x 4' x 4' / 610 x 1220 x 1220mm	32 lbs/15 kgs	44 lbs/20 kgs	54 lbs/25 kgs
Half Size	24" x 2' x 8' / 610 x 610 x 2440mm	32 lbs/15 kgs	44 lbs/20 kgs	54 lbs/25 kgs
Standard	24" x 4' x 8' / 610 x 1220 x 2440mm	64 lbs/30 kgs	88 lbs/40 kgs	108 lbs/50 kgs



11581-272 Street, Acheson, Alberta, Canada T7X 6E9  
6333 Unsworth Rd, Chilliwack, British Columbia, Canada V2R 5M3

Phone: 780 962-4433  
Fax: 780 962 4640  
Toll Free: 1 888 453 5961

™ REGISTERED TRADEMARK OF BEAVER PLASTICS LTD.

PRINTED IN CANADA